



FITTING INSTRUCTIONS FOR FI0043 FRAME INSERTS
KAWASAKI ZZR 1400 2012



THIS KIT CONTAINS THE ITEMS PICTURED AND LABELLED BELOW.
DO NOT PROCEED UNTIL YOU ARE SURE ALL PARTS ARE PRESENT.

Please note that the way the kit is packed does not necessarily represent the way of mounting to the bike

Please note that in cases where kits are packed with a plastic tube separating components on the spindle bar (this tube should be discarded).

THE PARTS SHOWN MAY BE REPRESENTATIVE ONLY (FOR CLARITY OF INSTRUCTIONS ONLY)

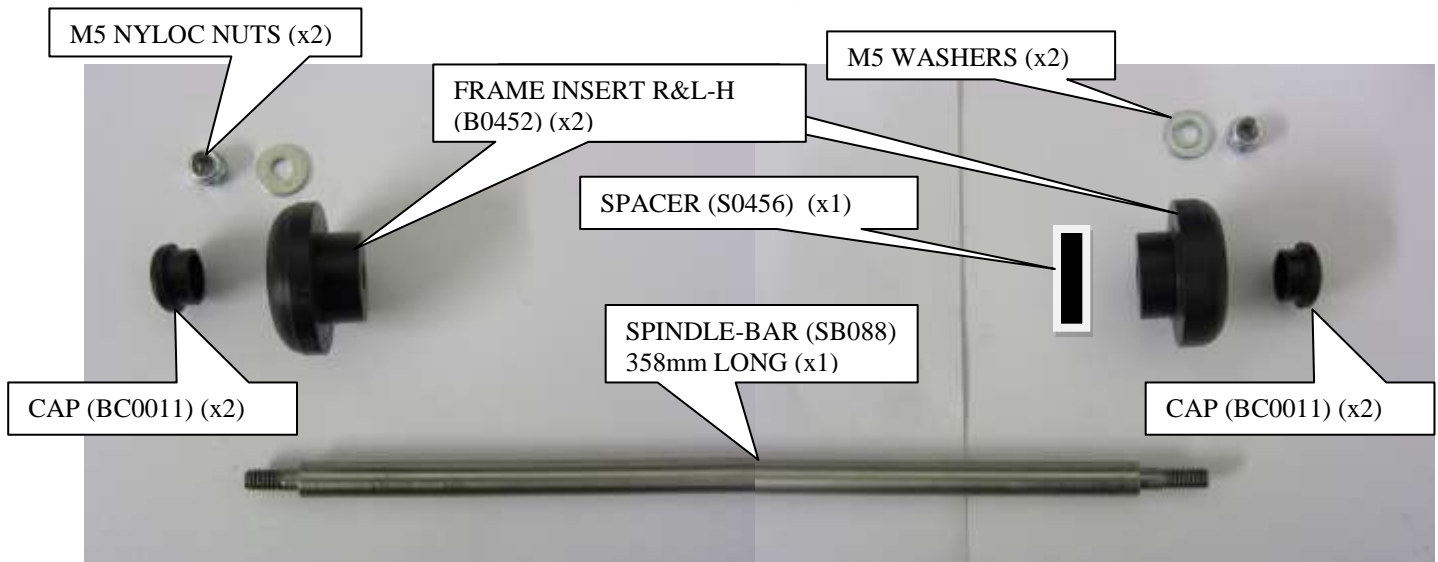



TOOLS REQUIRED

- Socket set to include 2x 8mm sockets and wrenches

FITTING INSTRUCTIONS

- Fit one nut and washer on spindle-bar, engage the nut so the plastic insert of nut is fully engaged.
- Feed spindle-bar with nut and washer through either frame insert.
- Place the spacer over the exposed end of the spindle-bar so it sits against the frame insert.
- Feed this assembly through the frame from the right hand side of bike.
- Place the remaining frame insert into frame and over the exposed end of the spindle bar.
- Fit washer and nut from kit onto thread and tighten until both nuts are engaged in nylon and equal amounts protrude from either side. Do not overtighten – the nyloc nuts will hold it tight.
- Gently fit the caps into both frame inserts.

ISSUE 1 31/05/2012 (NSY)

CONSUMER NOTICE

The catalogue description and any exhibition of samples are only broad indications of the Products and R&G may make design changes which do not diminish their performance or visual appeal and supplying them in such state shall conform to the order. The Buyer acknowledges no representation or warranty (other than as to title) has been given or will apply to the Products other than those in R&G's order or confirmation and the Buyer confirms it has chosen the Products as being of merchantable quality and suitable for its particular purposes. Where R&G fits the Products or undertakes other services it shall exercise reasonable skill and care and rectify any fault free of charge unless the workmanship has been disturbed. The Buyer is responsible for ensuring that the warranty on the motorcycle is not affected by the fitting of the Products. On return of any defective Products R&G shall at its option either supply a replacement or refund the purchase money but shall not be liable if the Products have been modified or used or maintained otherwise than in accordance with R&G's or manufacturer's instructions and good engineering practice or if the defect arises from accident or neglect. Other than identified above and subject to R&G not limiting its liability for causing death and personal injury, it shall not be liable for indirect or consequential loss and otherwise its liability shall be limited to the amounts paid by the Buyer for the Products or the fitting or service concerned. These terms do not affect the Buyer's statutory rights.

R&G RACING RETURNS POLICY (NON-FAULTY GOODS)

Returns must be pre-authorized (if not pre-authorized the return will be rejected). Goods may only be returned direct to us if they were purchased direct from us (customer must prove if necessary). Otherwise to be returned to original vendor. Goods must be in re-sellable condition, in the opinion of R&G Racing. All returns are subject to a 25% restocking and handling fee (25% of the gross value exc. P&P – at the prevailing price at time of purchase). The customer must pay any and all carriage charges. No returns of discontinued products, unless within 14 days of purchase. This policy does not affect your statutory rights and does not refer to faulty goods.

R&G Racing

Unit 1, Shelley's Lane, East Worldham, Alton, Hampshire, GU34 3AQ

Tel: +44 (0)1420 89007 Fax: +44 (0)1420 87301 www.rg-racing.com Email: info@rg-racing.com



Instructions de montage

FI0043 Inserts de cadre - KAWASAKI ZZR 1400 2012



Vérifier le contenu de la boîte avant de déballer les pièces. Ne pas procéder au montage s'en s'être assuré au préalable que les articles soient bien présents.

La façon dont le kit est emballé ne représente pas nécessairement la façon de le monter sur la moto.

S'il vous plaît noter que dans les cas où les kits sont emballés avec un tube en plastique séparant les composants sur la barre de broche, ce tube doit être jeté.

Les parties représentées peuvent parfois être uniquement représentatives
(Pour la clarté des explications).

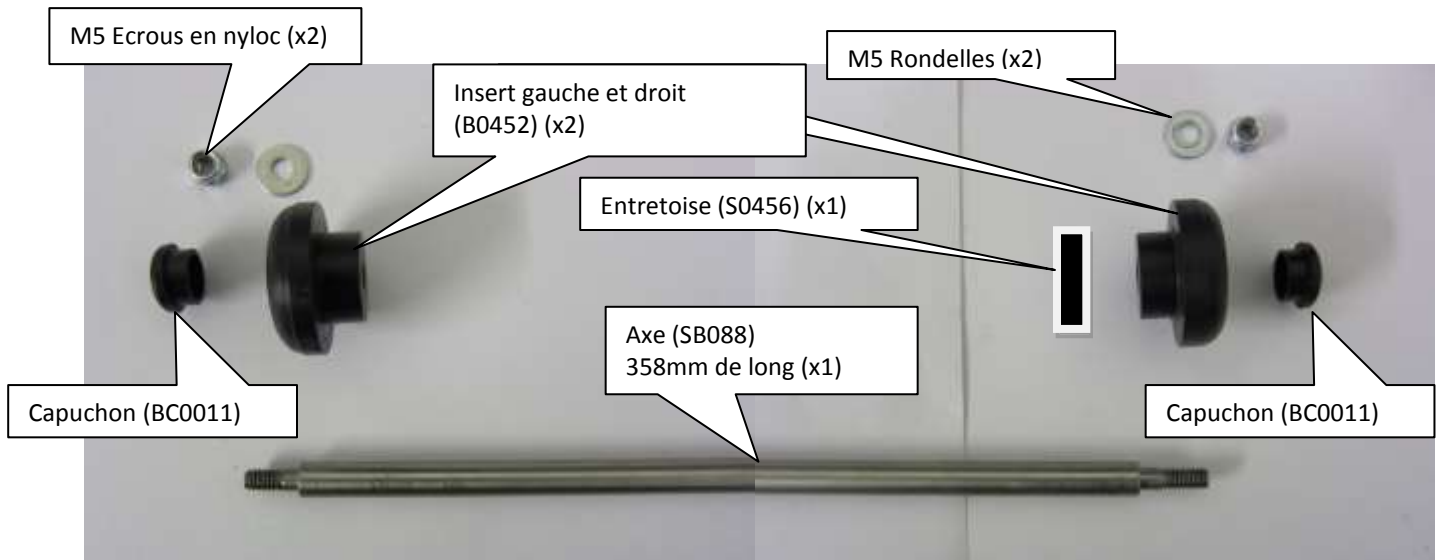

R&G Racing

Unit 1, Shelley's Lane, East Worldham, Alton, Hampshire, GU34 3AQ

Tel: +44 (0)1420 89007 Fax: +44 (0)1420 87301 www.rg-racing.com Email: info@rg-racing.com



Outils requis

- Clefs 2x8 mm

Instructions de montage

- Mettre une rondelle et un écrou sur l'axe, engager l'écrou de sorte à ce que l'insert en plastique de l'écrou soit complètement engagé.
- Passer l'axe à travers l'un des 2 inserts.
- Placer l'entretoise autour de l'extrémité de l'axe de façon à ce qu'elle se place contre l'insert de cadre.
- Passer l'ensemble à travers le cadre depuis le coté droit de la moto.
- Placer l'insert restant dans le cadre autour de l'extrémit de l'axe.
- Mettre la rondelle et l'écrou du kit sur le filetage puis serrer jusqu'à ce que les écrous soient engagés dans le nylon avec des dépassements égaux de chaque coté.
- **NE PAS TROP SERRER**
- Mettres les capuchons sur les inserts.